

## The law

The regulation requires that everyone at NTNU shall have fire drills and fire prevention courses.



## Brann

## Politi

## Ambulanse



110



112



113



### Når ulykke inntreffer

Den som først blir oppmerksom på at ulykke har skjedd, er ansvarlig for varsling. Du skal opplyse om:

- Hvem varsler
- Hva har skjedd
- Hvor er ulykkesstedet
- Hvor mange er skadet



### When an accident occurs

The first person at the scene is responsible for notification. Report:

- Who is calling
- What has happened
- Accident location
- How many are injured

### Viktige telefonnummer:

Vaktberedskap ved brann og ulykker NTNU

800 80 388

Beredskapstelefon SINTEF

73 53 50 00

NTNU vakt etter arbeidstid

918 97 373

Legevakt

07352

Giftinformasjonen

22 59 13 00

### Important Phone numbers:

Emergency NTNU

800 80 388

Emergency SINTEF

73 53 50 00

NTNU Security Guards after working hours

918 97 373

Medical Emergency

07352

Poisons Information Centre

22 59 13 00

### Møteplasser ved brann for

- Gloshaugen, Vermedtstrik og Egehuset



Møteplass

Meeting point



## BRANN- INSTRUKS

### Gjør deg kjent med:

- Rømningsveiene
- Nærmeste brannmelder
- Slokkeutstyrets plassering og virkemåte

### Hvis brann oppstår:

- Prøv å slukke brannet
- Utløs manuell brannmelder
- Ring brannvesenet på telefon 110

### Ved alarm:

- Lukk dører og vinduer
- Steng gasskraner og flaskeventiler
- Forlat bygningen
- Gå til møteplass
- Meld fra dersom du vet årsak til utløst alarm

Heis skal ikke benyttes ved brannalarm!



## FIRE REGULATIONS

### Make yourself familiar with:

- Evacuation routes
- Nearest fire alarm
- Location of extinguishers and how they work

### If a fire starts:

- Try to extinguish the fire
- Activate the manual fire alarms
- Call the Fire Department at tel. 110

### If the alarm sounds:

- Shut doors and windows
- Shut off gas taps and cylinder valves
- Leave the building
- Go to the assembly point
- Please report if you know what caused the alarm

Lifts must not be used during fire alarms!

## **Make your self familiar with:**

- Evacuation routes
- Manual fire alarms
- Location of fire extinguishers and how they work

## **If a fire starts:**

- Try to extinguish the fire
- Activate the fire alarm (**red boxes**)
- Call the fire brigade (**110**)

## **If the alarm sounds:**

- Shut windows and doors
- Shut off gas taps and cylinder valves
- Leave the building
- Go to the meeting point
- Report if you know what caused the alarm
- Lifts must not be used during fire alarms

# Fire extinguishers at NTNU



Powder



Foam



CO<sub>2</sub>



Water

## Fire Cell Division

The buildings are designed so that a fire should be able to develop freely in a room for about half an hour without it spreading to other rooms.

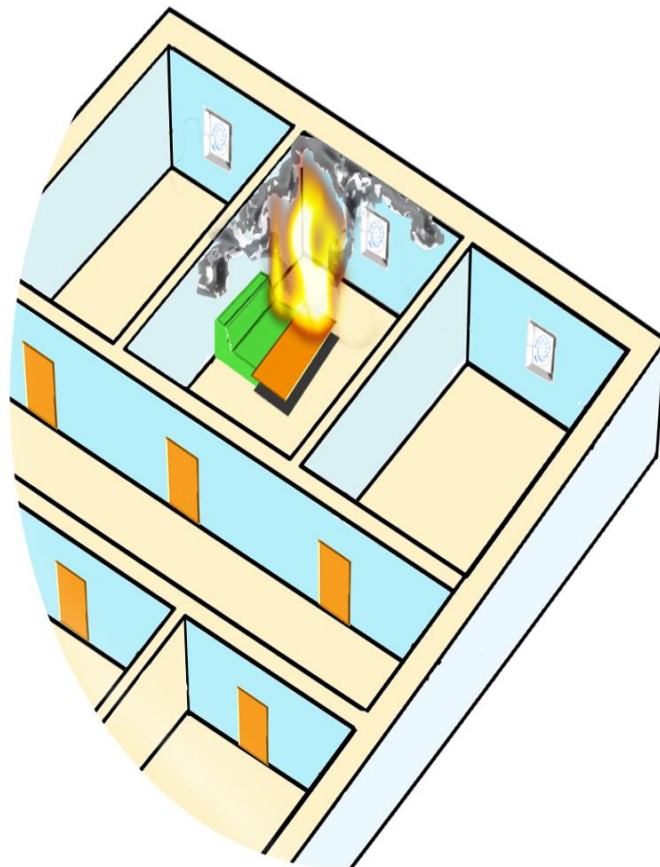



## Prerequisites for the fire cell division to work

A prerequisite for the fire cell division to work is that the door is closed when a fire occurs.

The use of wedges is prohibited!

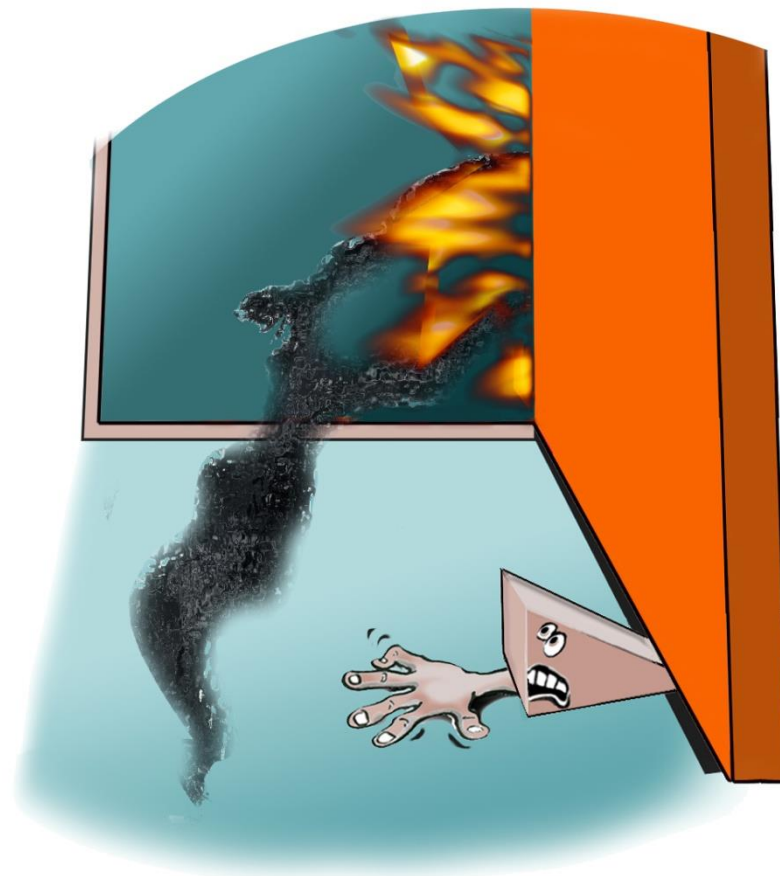

If you discover a fire don't hesitate to use the manual firealarm boxes ---->



If you upon evacuation is stopped by a locked door, look for these boxes nearby the door to manually open it ---->



## Evacuating

If you discover a fire in your area you shall evacuate immediately from the burning room and out of the building. Follow the green exit signs and gather at meeting point. Assist people in need.

If it's a small fire you can try to put out the fire with a fire extinguisher. **BUT NEVER PUT YOUR OWN SAFETY AT RISK!**





- **Evening/weekend**

Call the fire department 110 or NTNU safety guards 918 97 373 (24 hours) if you experience difficulty getting out of a fire - and evacuation situation.

## People with disabilities and fire / evacuation

We ask all those who feel the need for assistance with evacuation to speak out so that assistance can be organized from staff (rescue seat or assistance from staff)

Students notifies the faculty advisor for the disabled, Sigurd Madsen, or Facilitation Service.



# Fire instructions and evacuation

- Become familiar with the **meeting point** for evacuation and who is the area manager
- **Area Manager “Områdeansvarlig”** (orang vest) to help ensure that everyone evacuates.
- Share information that you may have.



Fire develops quickly. Do not sit around and wait until you see smoke if a firealarm is set off.

Poisonous gas will occur in your area long before you will notice the smoke. Start evacuation immediately.

80% of fire deaths are caused by smoke inhalation/poisonous gas, not burns.



